

## SHORT-FIBRE REINFORCED FLOWABLE COMPOSITE FOR DENTIN REPLACEMENT

### Direct restorations

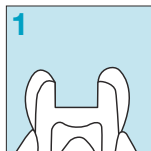

1 Prepare cavity.

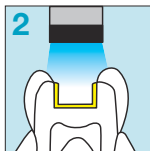

2 Bond and light-cure.



3 Place everX Flow; leave sufficient space for the overlaying composite.

**Class II and large cavities**

3a

3b

Build first the missing walls using a conventional light-cured restorative composite. The wall should be thick enough to withstand the application pressure of everX Flow.

#### Irradiation Time and Effective Depth of Cure

Irradiation time		
Shade	10 sec. (High Power LED) (>1200 mW/cm <sup>2</sup> )	20 sec. (Halogen/ LED) (>700 mW/cm <sup>2</sup> )
Bulk shade	5.5 mm	
Dentin shade	2.0 mm	



The Bulk shade can be placed using a bulk filling technique (up to 5.5mm). The Dentin shade should be placed and light-cured in layers of 2.0mm.

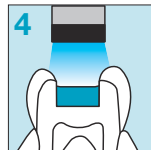

4 Light-cure.

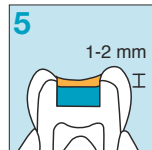

5 Cover with composite.

## SHORT-FIBRE REINFORCED FLOWABLE COMPOSITE FOR DENTIN REPLACEMENT

### Core build-up

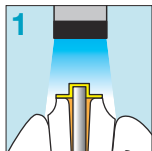

1 Prepare the surfaces to be bonded. Bond and light-cure.

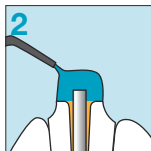

2 Use everX Flow to build the core.

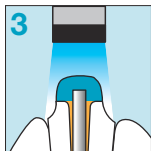

3 Light-cure.

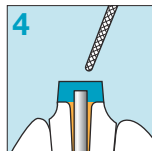

4 Contour & finish the core.

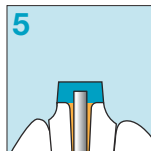

5 Final core build-up preparation.

#### Irradiation Time and Effective Depth of Cure

Irradiation time	10 sec. (High Power LED) (>1200 mW/cm <sup>2</sup> )
Shade	20 sec. (Halogen/ LED) (>700 mW/cm <sup>2</sup> )
Bulk shade	5.5 mm
Dentin shade	2.0 mm



The final indirect restoration should fully cover the everX Flow core build-up.



Prior to use, carefully read the instructions for use.